

DIVERSION ROUTES AND SIGNAGE: NOT TO SCALE

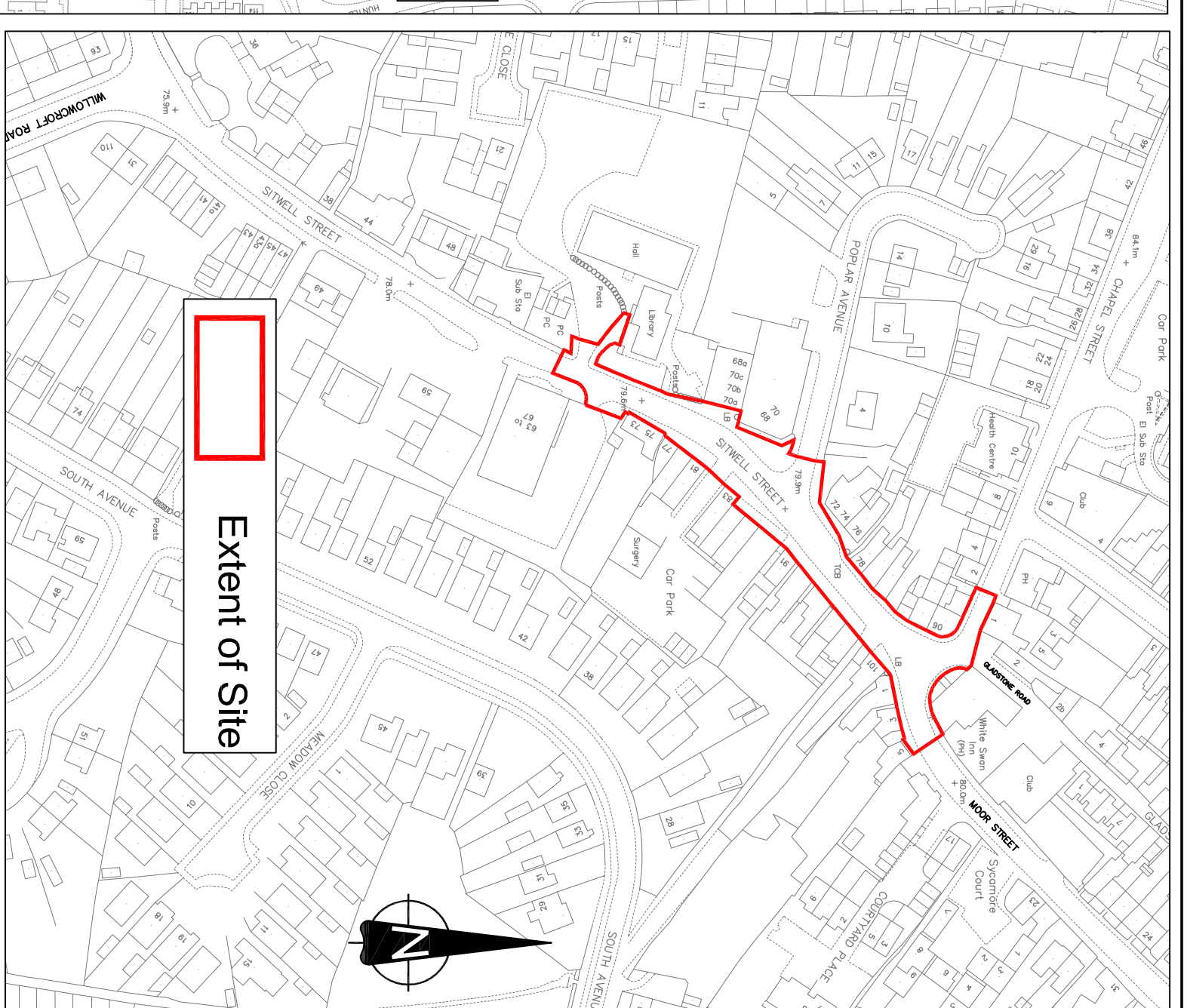

LOCATION PLAN: NOT TO SCALE

- NOTES**
1. Do Not Scale.
 2. All distances in metres unless otherwise stated.
 3. All discrepancies are to be reported to the Project Manager.
 4. This drawing to be read in conjunction with:
 - Standard Detail and Scheme-Specific Detail drawings
 - Specification Appendices and Clauses
 - Contractor shall erect, maintain and take down traffic management and associated diversions in accordance with Specification Appendices 1/17-1/18. Layouts to be approved prior to commencement of the Works.
 - 6. For scheme Site Plans see drawing nos 12048/02 and 05 and subsequent amendments.
 - 7. Final location and mounting details of temporary diversion signs to be agreed in advance with the supervising engineer
 - 8. The Contractor is to monitor traffic queues on Church Street at the junction of Church Street, Lodge Lane and Swell Street. See Appendix 1/17.

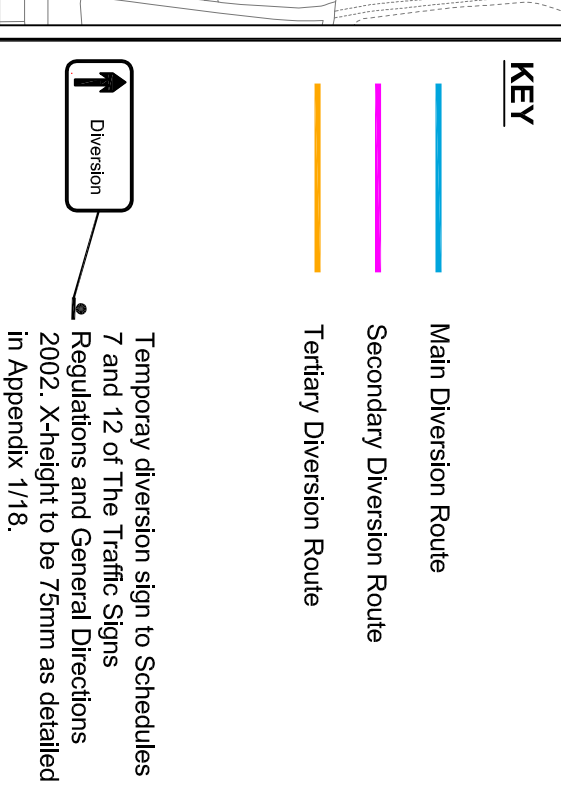

Signage amendments at:

1. Willington Rd/Swell Ave
2. Swell St/Lodge Lane
3. Lodge Rd/Sancton Rd

AMENDMENT DETAILS	BY	CHKD	DATE	REV.
VT	MB	17/11/13	A	

APPROVED FOR CONSTRUCTION

STATUS	DATE	BY	CHKD	DATE	REV.
AMENDMENT DETAILS	01/11/2012	M. BADOLEY	NTS		



NEIGHBOURHOODS
 Strategic Director
 Paul Robinson
 Saxon House
 Heritage Gate
 Friary Street
 Derby DE1 1AN
 Tel: (01332) 293111 Fax: (01332) 255959

PROJECT TITLE
 SITWELL STREET, SPONDON
 (SPONDON LIBRARY TO MOOR ST)
 FOOTWAY R&R SCHEME

DRAWING TITLE
 DIVERSION ROUTES
 AND SIGNAGE

PROJECT REFERENCE NUMBER	DRAWING NUMBER	REVISION
HD12048	12048/06	A

Safety, Health and Environmental Information
 In addition to the hazards/risks normally associated with the types of work detailed on this drawing, note the following significant residual risks.

Construction
 None

Maintenance/Cleaning
 None

Use
 None

Decommissioning/Demolition
 None